

H1

Quick Installation Guide

English (EN)	2
简体中文 (ZH)	4
Deutsch (DE)	6
Español (ES)	8
Français (FR)	10
Italiano (IT)	12
Português (PT).....	14

English (EN)

Precautions

Warning: Please do not power cycle the device during system boot up or firmware upgrade. You may corrupt firmware images and cause the unit to malfunction.

Warning: Use only the power adapter included in the device package. Using an alternative non-qualified power adapter may possibly damage the unit.

Overview

Fanvil H1 is a hotel IP phone with a cost-effective, multi-function, and elegant appearance. It is equipped with 8 programmable soft keys for the services hotline, meeting the application requirements of various hotel scenarios. In addition, H1 supports functions such as HD audio, 10/100Mbps network port, and integrated PoE, providing a high-quality user experience and reducing the cost of hotel deployment. It is more than a hotel phone and also can be applied in multiple scenarios, such as shopping malls, hospitals, and supermarkets.

Packaging list

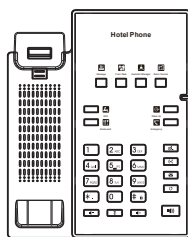

IP Phone

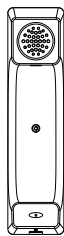

Handset

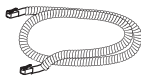

Handset Cord



Ethernet Cord

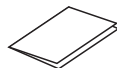

Quick Installation Guide



Stand



Power Adapter
(Optional)

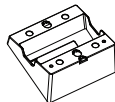

Wall Stand
(Buy separately)

Keys description

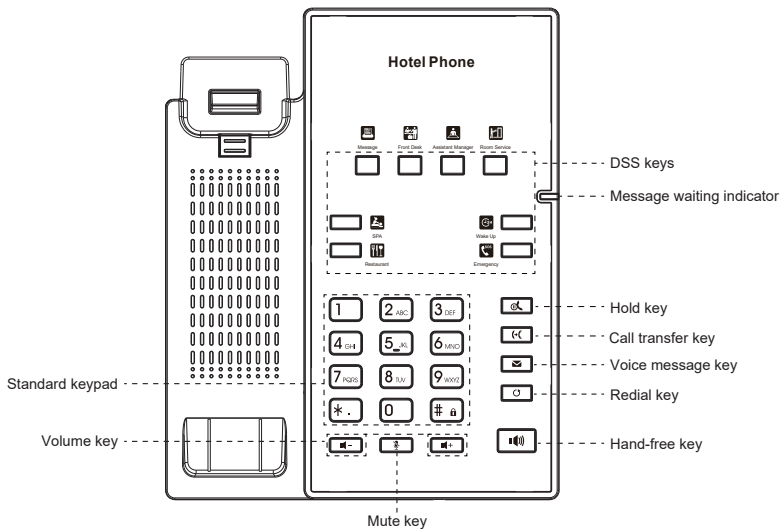

Device installation

Please follow the instructions in below picture to install the device.

• Bracket desktop installation

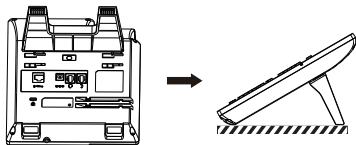

• Wall mounting (wall stand need buy separately)

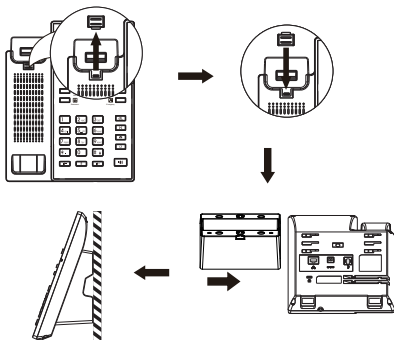

• Connecting to the device

Please connect power adapter, network, and handset to the corresponding ports as described in below picture.

- 1 Network port: connecting local area network or Internet.
- 2 Power port: connect the power adapter.
- 3 Handset port: connect IP Phone handset.

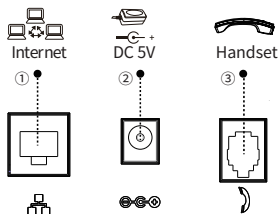

Network connect

Using Ethernet

1. The power on the device and connect the WAN port of the phone to the RJ45 socket of a hub/switch or a router (LAN side of the router) using the Ethernet cable.
2. The default is DHCP mode.

Phone configuration

Configuration via web

1. Get the IP address : Press the “#” key for more than 6 seconds to broadcast IP;
2. Login: Input the IP address in the web browser. The PC and phone should be in the same IP address segment (The default username and password are both ‘admin’);
3. Configure: Select network/account etc, and fill the relevant content;
4. Save the configuration.

Making a call

1. **Pre-dialing**: enter the phone number and pick up the handset.
2. **Direct dialing**: lift the handset and enter the phone number.
3. **Handsfree**: enter phone number and press **[M]** or vice versa.
4. **Memory key**: press memory key.

Accepting a call

1. **Using the handset**: pick up the handset.
2. **Using the handsfree**: press **[M]**.

Redial

1. Press **[R]** key, redial a call number.

Note: You can contact your service provider for additional settings that may be necessary to con-figure the phone, or download the user manual and FAQ for more detailed information.

简体中文 (ZH)

注意事项

警告: 请不要在设备启动未完成或设备升级软件时断开电源, 因为如刚才所述的操作将会导致话设备本身的程序损坏, 进而导致设备无法启动。

警告: 请使用设备包装中的电源适配器, 因为使用其他没有经过认证的替代电源适配器有可能对设备造成损害。

产品概览

方位H11作为一款高性价比、多功能、外观优雅的酒店IP话机, 方位H11配备8个可编程键, 满足丰富的酒店入住场景应用需求。它支持高清语音、百兆以太网和PoE供电等功能, 提供优质的用户体验, 降低酒店部署成本。除了酒店场景之外, H11还适用于商场、医院、超市等应用场景。

包装清单

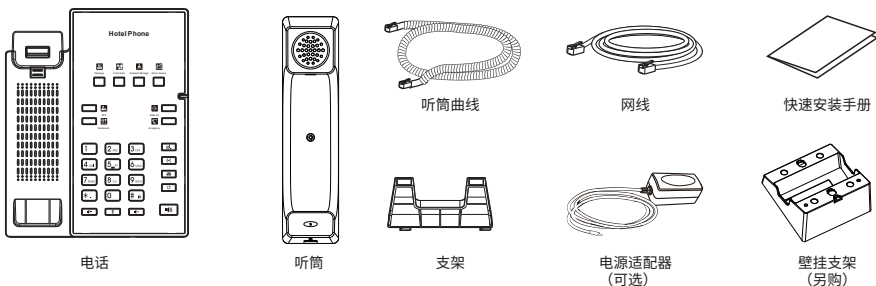

按键概览

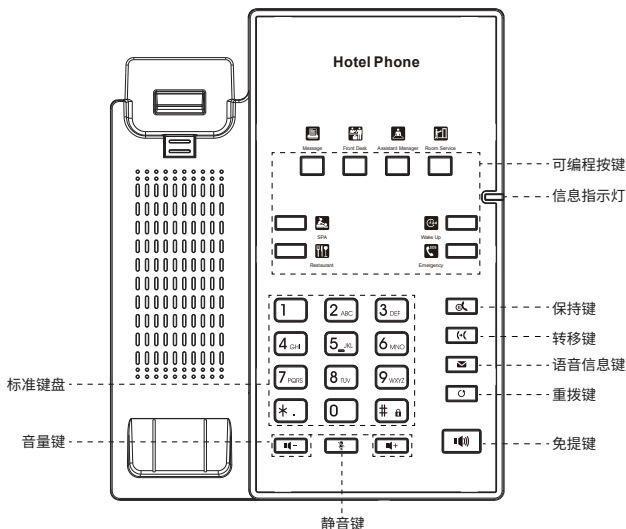

设备安装

请按照下面图片中的说明安装话机。

• 桌面支架安装

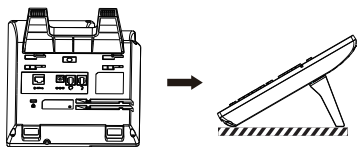

• 壁挂式安装 (壁挂支架需另外购买*分开销售)

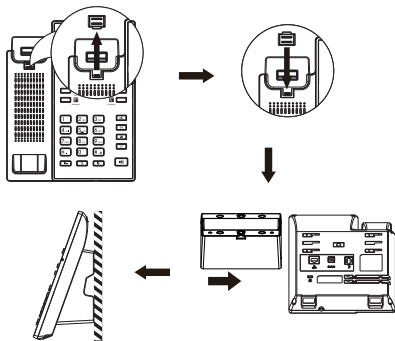

• 设备连接

请按下图说明将电源适配器, 网络, 听筒连接到相应的端口。

- ① 网络接口: 连接局域网或者互联网。
- ② 电源接口: 连接电源适配器。
- ③ 听筒接口: 连接话机听筒。

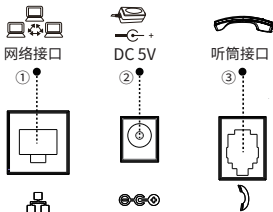

注意: 如有其他需要的设置, 请联系您的服务提供商, 或下载用户手册和常见问题解答以获得更详细的配置说明。

网络连接

通过以太网连接

1. 打开设备电源, 并将话机的广域网端口连接到集线器/交换机或路由器的RJ45插座, 使用网线连接。
2. 默认为DHCP模式。

电话设置

通过网页配置

1. 查询IP地址: 长按“#”键(6秒以上), 将语音播报设备IP;
2. 登录: 在网页浏览器上输入IP地址。电脑和电话应该处于同一个IP地址段, 默认的用户名和密码都是“admin”;
3. 配置: 选择网络/账号等, 并填写相关内容;
4. 保存配置。

拨打电话

1. 预拨号: 先输入电话号码, 再拿起听筒。
2. 直接拨号: 先拿起听筒, 再输入电话号码。
3. 免提: 先输入电话号码, 再按下 **☎**; 顺序反之操作亦可。
4. 记忆键拨号: 按指定的记忆键呼叫。

接听电话

1. 使用听筒接听: 拿起听筒。
2. 使用免提接听: 按下 **☎**。

重拨

1. 按下 **☎** 键, 重拨上一个呼叫号码。

Deutsch (DE)

Warnung

Warnung: Schalten Sie das Gerät während des Systemstarts oder Firmware-Upgrades nicht aus und wieder ein. Sie können Firmware-Images beschädigen und eine Fehlfunktion des Geräts verursachen.

Warnung: Verwenden Sie nur das im Lieferumfang des Geräts enthaltene Netzteil. Die Verwendung eines alternativen, nicht qualifizierten Netzteils kann das Gerät möglicherweise beschädigen.

Überblick

Fanvil H1 ist ein Hotel-IP-Telefon mit einem kostengünstigen, multifunktionalen und eleganten Erscheinungsbild. Es ist mit 8 programmierbaren Softkeys für die Service-Hotline ausgestattet und erfüllt so die Anwendungsanforderungen verschiedener Hotelszenarien. Darüber hinaus unterstützt H1 Funktionen wie HD-Audio, 10/100 Mbit/s-Netzwerkanschluss und integriertes PoE, was ein hochwertiges Benutzererlebnis bietet und die Kosten für die Hotelbereitstellung senkt. Es ist mehr als ein Hoteltelefon und kann auch in verschiedenen Szenarien eingesetzt werden, beispielsweise in Einkaufszentren, Krankenhäusern und Supermärkten.

Lieferumfang

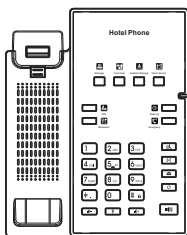

IP Telefon

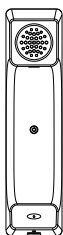

Hörer



Hörer Kabel



Netzwerk-Kabel



QIG

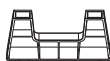

Standfuß

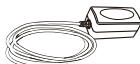

Netzteil
(Optional)

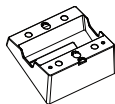

Wand-Montageplatte
(Separat erhältlich)

Tasten

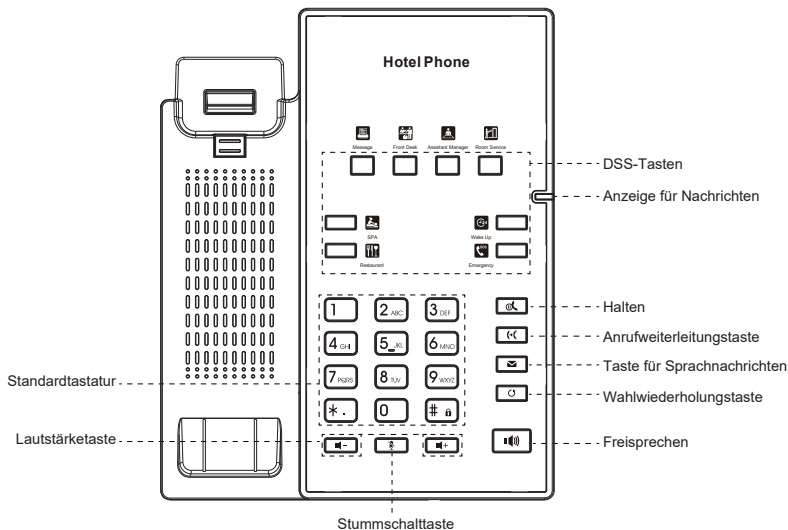

Installation

Bitte folgen Sie den untenstehenden Anweisungen

• Installation Standfuß

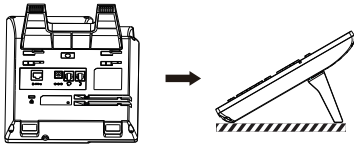

• Wand-Montage-Platte (separat erhältlich)

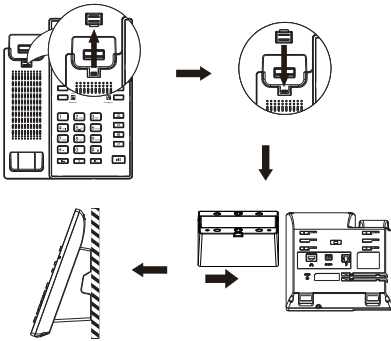

• Anschließen

Bitte schließen Sie das Netzteil, das Netzwerk und das Mobilteil an die entsprechenden Anschlüsse an, wie im Bild unten beschrieben.

- 1 Netzwerkanschluss: Anschluss eines lokalen Netzwerks oder das Internet.
- 2 Stromanschluss: Schließen Sie das Netzteil an.
- 3 Höreranschluss: Anschluss des IP-Telefon-Hörers.

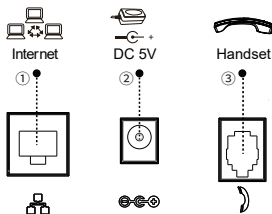

Netzwerkverbindung

Verwendung von Ethernet

1. Schalten Sie das Gerät ein und verbinden Sie den WAN-Port des Telefons über das Ethernet-Kabel mit der RJ45-Buchse eines Hubs/Switches oder eines Routers (LAN-Seite des Routers).
2. Die Standardeinstellung ist der DHCP-Modus.

Konfiguration

Konfiguration über Web

1. IP-Adresse abrufen: Drücken Sie die „#“-Taste länger als 6 Sekunden, um die IP-Adresse zu übertragen.
2. Geben Sie die IP-Adresse in den Webbrowser ein. Der PC und das Telefon sollten sich im gleichen IP-Adressensegment befinden (der Standard-Benutzername und Passwort ist "admin").
3. Konfigurieren: Wählen Sie Netzwerk/Konto usw. und füllen Sie die Felder aus.
4. Speichern Sie die Konfiguration.

Anruf aufbauen

1. **Wahlvorbereitung:** Geben Sie die Nummer ein und nehmen Sie den Hörer ab.
2. **Direktwahl:** Heben Sie den Hörer ab und wählen Sie die Nummer.
3. **Freisprechen:** Geben Sie eine Telefonnummer ein und drücken Sie **☎**.
4. **Speichertaste:** Drücken Sie die Speichertaste

Anruf annehmen

1. **Hörer:** Nehmen Sie den Hörer ab.
2. **Freisprechen:** Drücken Sie **☎**.

Wahlwiederholung

1. Drücken Sie **↺** um eine gewählte Nummer erneut zu wählen.

Hinweis: Wenden Sie sich für weitere Einstellungen zur Konfiguration des Telefons an Ihren Diensteanbieter oder laden Sie das Benutzerhandbuch und die häufig gestellten Fragen herunter, um detailliertere Informationen zu erhalten.

Español (ES)

Precauciones

Advertencia: Por favor, no apague el dispositivo durante el arranque del sistema o la actualización del firmware. Podría corromper las imágenes del firmware y causar un mal funcionamiento de la unidad.

Advertencia: Utilice únicamente el adaptador de corriente incluido en el paquete del dispositivo. El uso de un adaptador de corriente alternativo no calificado puede dañar la unidad.

Visión General

Fanvil H1 es un teléfono de hotel IP con multi funciones y elegante a un precio competitivo. Está equipado con 8 teclas programables para llamadas directas en diferentes servicios. Además, H1 dispone de funciones tales como, audio HD, puerto red 10/100Mbps y PoE integrado, suministra una calidad superior a reducido coste para instalar en hoteles.

Lista de embalaje

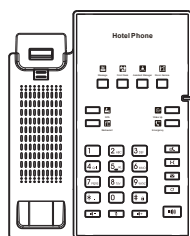

Teléfono IP

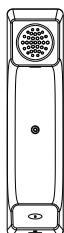

Auricular

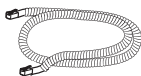

Cable de telefono



Cable Ethernet

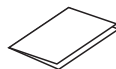

Guía de instalación rápida



Soporte



Adaptador de corriente
(Opcional)

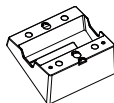

Soporte de pared
(Adquirido por separado)

Descripción de las teclas

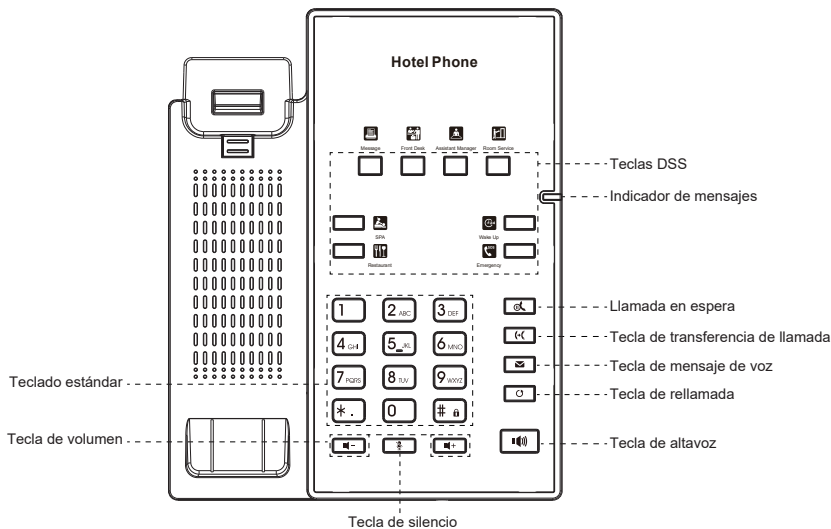

Instalación del dispositivo

Siga las instrucciones en la imagen a continuación para instalar el dispositivo.

• Instalación de soporte de escritorio

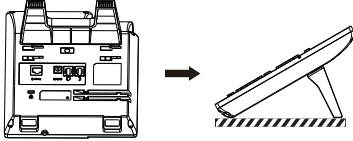

• Montaje en la pared (soporte de pared para comprar por separado)

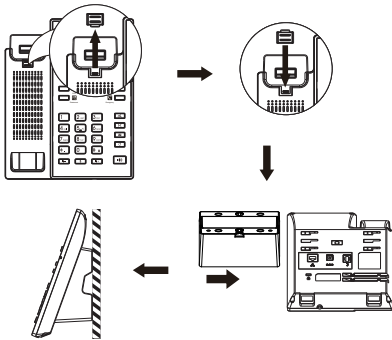

• Conéctese al dispositivo

Por favor conecte el alimentador, el cable de red y el auricular a sus correspondientes puertos descritos en la fotografía de abajo.

- 1 Puerto de red: conexión de red de área local o Internet.
- 2 Puerto de alimentación: conecta el adaptador de corriente.
- 3 Puerto del auricular: conecte el auricular del teléfono IP.

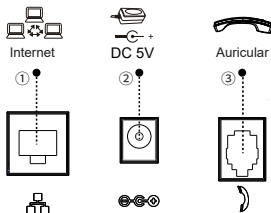

Conexión de red

Uso de Ethernet

1. Encienda el dispositivo y conecte el puerto WAN del teléfono a la toma RJ45 de un concentrador/conmutador o un enrutador (lado LAN del enrutador) usando el cable Ethernet.
2. El valor predeterminado es el modo DHCP.

Configuración del teléfono

Configuración vía web

1. Para obtener la dirección IP: presione la tecla # durante 6 segundos y la dirección IP será reproducida.
2. Iniciar sesión: ingrese la dirección IP en su navegador web. PC y el teléfono debe estar en el mismo segmento de dirección IP (El nombre de usuario y la contraseña predeterminados son 'admin').
3. Configuración: seleccione la red/número de cuenta, etc. Y complete el contenido relevante.
4. Guarde la configuración.

Haciendo una llamada

1. **Marcación previa:** introduce el número de teléfono y levante el auricular.
2. **Marcación directa:** levante el auricular e introduce el número de teléfono.
3. **Manos libres:** introduce el número de teléfono y pulsa o viceversa.
4. **Tecla de memoria:** presione la tecla de memoria

Responder una llamada

1. **Usar el teléfono:** tomar el auricular.
2. **En altavoz:** presione .

Marcar de nuevo

1. Pulse el botón para volver a marcar el número llamar.

Nota: Puede ponerse en contacto con el técnico que instaló el producto para cualquier configuración adicional que pueda necesitar para configurar su teléfono, o descargar el manual del usuario y las preguntas frecuentes para obtener información más detallada.

Français (FR)

Précautions

Avertissement: Ne coupez pas l'alimentation pendant le démarrage du système ou la mise à niveau du firmware. Vous risquez d'endommager l'image du firmware et de provoquer une défaillance de l'unité.

Avertissement: Utilisez uniquement l'adaptateur inclus dans le pack. L'utilisation d'un autre adaptateur d'alimentation non conforme peut endommager l'unité.

Aperçu

Le Fanvil H1 est un téléphone IP d'hôtel élégant, polyvalent et économique. Avec ses 8 touches programmables, il permet aux clients d'accéder facilement aux différents services d'hôtel, tels que la réception, le restaurant etc. De plus, il prend en charge une qualité audio HD, un port réseau 10/100 Mbps et PoE intégrée, offrant ainsi une expérience utilisateur optimale tout en réduisant les coûts de déploiement. En plus d'être idéal pour les hôtels, le Fanvil H1 s'adapte également à divers scénarios d'utilisation tels que les centres commerciaux, les hôpitaux et les supermarchés.

Contenu

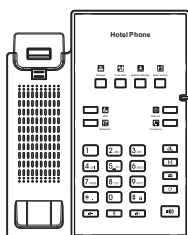

Téléphone

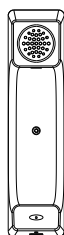

Combiné

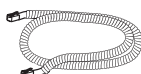

Cordon de raccordement du combiné



Câble Ethernet



Guide d'installation rapide



Support de bureau



Adaptateur secteur (facultatif)

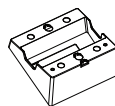

Étagères murales (Acheté séparément)

Description des touches

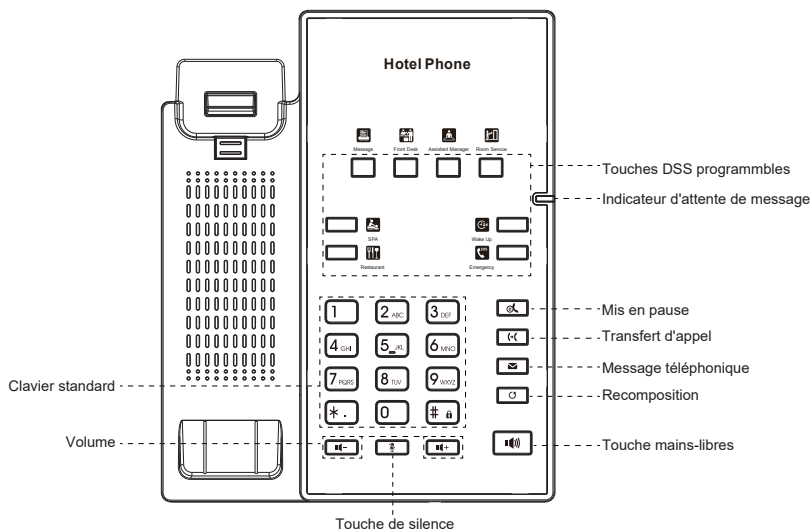

Installation des équipements

Veillez suivre les instructions de l'image ci-dessous pour installer l'appareil.

• Installation de support de bureau

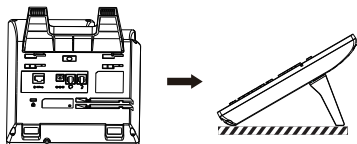

• Montage mural (support mural à acheter séparément)

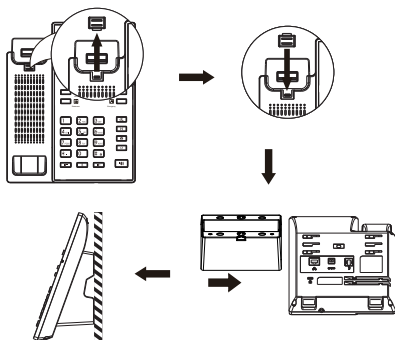

• Se connecter à un appareil

Connectez l'adaptateur secteur, le réseau et le combiné aux ports correspondants décrits dans la figure ci-dessous.

- ① Port réseau: Connectez-vous au LAN ou à Internet.
- ② Port d'alimentation: Connectez l'adaptateur d'alimentation.
- ③ Port combiné: Connectez le combiné.

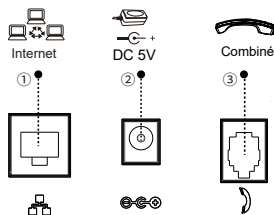

Remarque: Vous pouvez contacter votre fournisseur de services pour obtenir les paramètres supplémentaires nécessaires à l'installation du téléphone, ou télécharger le manuel d'utilisation et la FAQ pour plus d'informations.

Connexion au réseau

Utilisation d'Ethernet

1. Allumez l'appareil et connectez le port WAN du téléphone à la prise RJ45 d'un concentrateur/commutateur ou d'un routeur (via le port LAN) à l'aide du câble Ethernet.
2. Le mode DHCP est sélectionné par défaut.

Configuration du téléphone

Configuration via web

1. Pour obtenir l'adresse IP du téléphone: appuyez sur la touche '#' pendant au moins 6 secondes pour diffuser votre adresse IP.
2. Connexion: Entrez votre adresse IP dans votre navigateur web. Le PC et le téléphone doivent être dans le même segment d'adresse IP (le nom d'utilisateur et le mot de passe par défaut sont tous deux 'admin'.)
3. Configuration: Sélectionnez le réseau/numéro de compte, etc., remplissez le contenu si besoin.
4. Enregistrez la configuration.

Appel téléphonique

1. **Pré-composition:** Entrez le numéro de téléphone et décrochez votre combiné.
2. **Composition directe:** Soulevez votre combiné et entrez le numéro de téléphone.
3. **Mains libres:** Entrez le numéro de téléphone et appuyez sur  ou vice versa.
4. **Touche de mémoire:** appuyez sur la touche de mémoire

Répondre aux appels

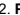
1. **Utilisation du combiné:** Prenez le combiné.
2. **Pour utiliser le mode mains libres:** Appuyez sur  .

Recomposition

1. Appuyez sur la touche  et recomposez le numéro.

Installazione del dispositivo

Installare il dispositivo seguendo le istruzioni nella figura seguente.

• Montaggio supporto da scrivania

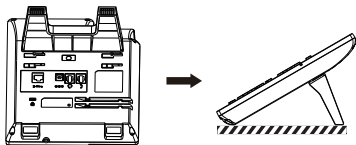

• Montaggio a parete (supporto da muro da acquistare separatamente)

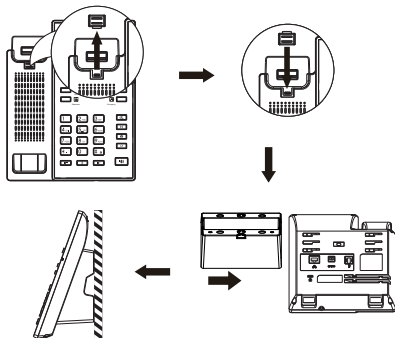

• Connessione del dispositivo

Collegare l'adattatore di alimentazione, la rete e il ricevitore alle porte corrispondenti come descritto nell'immagine seguente.

- 1 Porta di rete: Connessione alla LAN o a Internet.
- 2 Porta di alimentazione: collegare l'adattatore di alimentazione.
- 3 Porta microtelefono: Collegare la cornetta.

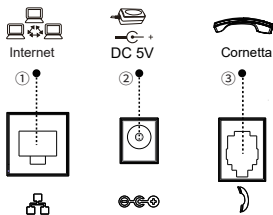

Nota: è possibile contattare il tecnico che ha installato il prodotto per ulteriori impostazioni che potrebbero essere necessarie per configurare il telefono o scaricare il manuale utente e le domande frequenti per informazioni più dettagliate.

Connessione di rete

Connessione via cavo Ethernet

1. Accendere il dispositivo e collegare la porta WAN del telefono alla presa RJ45 di un hub/switch o di un router (lato LAN del router) utilizzando il cavo Ethernet.
2. L'impostazione predefinita è DHCP.

Configurazione del telefono

Configurazione via web

1. Ottieni l'indirizzo IP: premi il tasto "#" per più di 6 secondi per ascoltare l'IP
2. Login: inserisci l'indirizzo IP nel tuo browser web. PC e telefono dovrebbero trovarsi nella stessa sottorete (il nome utente e la password predefiniti sono 'admin'.)
3. Configurazione: selezionare la rete/account, ecc. Compilando i campi correttamente.
4. Salvare la configurazione.

Esecuzione di una chiamata

1. **Pre-composizione:** inserisci il numero di telefono e alza il ricevitore.
2. **Composizione diretta:** sollevare il ricevitore e inserire il numero di telefono.
3. **In vivavoce:** inserisci il numero di telefono e premi o viceversa.
4. **Tasto memoria:** premere il tasto memoria.

Risposta a una chiamata

1. **Usa il telefono:** prendi il ricevitore.
2. **In vivavoce:** premere .

Ricomponi

1. Premere il pulsante o per ricomporre il numero chiamato.

Português (PT)

Precauções

Aviso: Não desligue e ligue o dispositivo durante a inicialização do sistema ou atualização do firmware. Você pode corromper arquivos de firmware e causar que a unidade tenha problemas.

Aviso: Use apenas o adaptador de energia incluído no embalagem do dispositivo. O uso de um adaptador de energia alternativo não qualificado pode danificar a unidade.

Visão geral

O Fanvil H1 é um telefone IP para hotel com uma aparência multifuncional e elegante. Ele está equipado com 8 softkeys programáveis para linha direta de serviços, atendendo aos requisitos de aplicação de diversos cenários hoteleiros. Além disso, o H1 suporta funções como áudio HD, porta de rede 10/100 Mbps e PoE integrado, proporcionando uma experiência de usuário de alta qualidade e reduzindo o custo de implantação em hotéis. É mais que um telefone de hotel, também pode ser aplicado em diversos cenários, como shoppings, hospitais e supermercados.

Lista de Embalagem

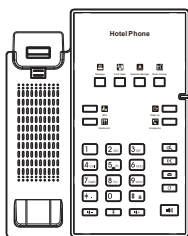

Telefone IP

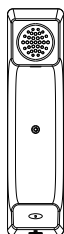

Handset

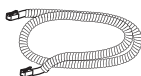

Cabo do Handset



Cabo Ethernet

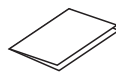

Guia de Instalação Rápida



Base

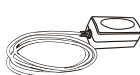

Fonte
(Opcional)

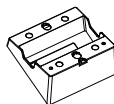

Base de Parede
(Adquirido Separadamente)

Descrição das Teclas

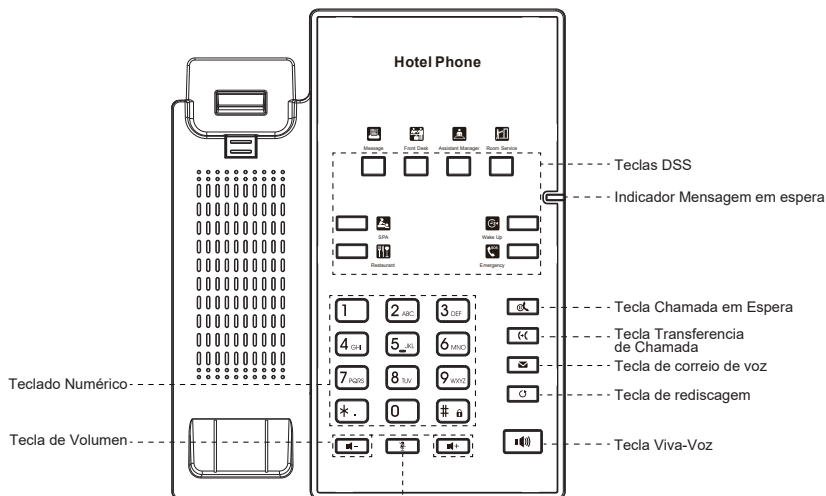

Instalação do dispositivo

Siga as instruções na imagem abaixo para instalar o dispositivo.

• Instalação no base de suporte



• Montagem na parede (suporte é adquirido separadamente)

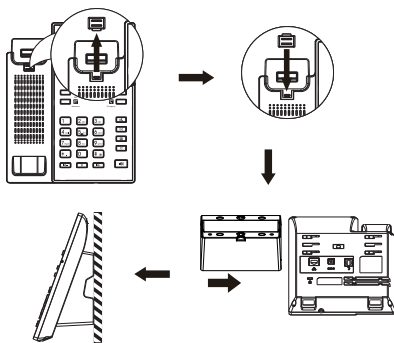

• Ligar o dispositivo

Conecte o adaptador de energia, a rede e o fone às portas correspondentes conforme descrito na imagem abaixo.

- 1 Porta de rede Ethernet: Ligar na rede LAN ou Internet.
- 2 Porta de energia DC 5V: Ligar o adaptador de energia.
- 3 Porta do headset: Ligar o headset.

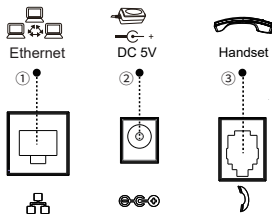

Conexão de rede

Usando Ethernet

1. Ligue o dispositivo e conecte a porta WAN do telefone ao soquete RJ45 de um hub/switch ou roteador (lado LAN do roteador) usando o cabo Ethernet.
2. O padrão é o modo DHCP.

Configuração do Telefone

Configuração via web

1. Obtenha o endereço IP: Pressione a tecla "#" por mais de 6 segundos para obter o IP;.
2. Login: Insira o endereço IP no navegador da web. O PC e o telefone devem estar no mesmo segmento de rede (o nome de usuário e a senha padrão são 'admin'.)
3. Configurar: Selecione rede/conta etc, e preencha o conteúdo relevante.
4. Salve a configuração.

Fazer uma chamada

1. **Pré-discagem:** digite o número do telefone e tire do handset.
2. **Discagem direta:** tire do handset e digite o número do telefone.
3. **Viva-Voz:** digite o número do telefone e pressione ou também vice versa.
4. **Tecla de memória:** pressione a tecla de memória.

Atender uma chamada

1. **Usando o handset:** tire do handset.
2. **Usando o viva-voz:** pressione .

Rediscagem

1. Pressione a tecla , para rediscar o número de chamada.

Note: Você pode entrar em contato com seu provedor de serviços para obter configurações adicionais que possam ser necessárias para configurar o telefone ou também descarregar o manual do usuário e perguntas frequentes para obter informações mais detalhadas.

Regulatory Compliance

Federal Communication Commission (FCC) — USA

This device complies with Part 15 of FCC Rules. Operation is subject to the following two conditions: (1) this device may not cause harmful interference, and (2) this device must accept any interference received; including interference that may cause undesired operation.

This equipment has been tested and found to comply with the limits for a Class B digital device, pursuant to Part 15 of the FCC Rules. These limits are designed to provide reasonable protection against harmful interference in residential installation. This equipment generates, uses, and can radiate radio frequency energy, and if it is not installed and used in accordance with the instruction manual, it may cause harmful interference to radio communications. However, there is no guarantee that interference will not occur in a particular installation. If this equipment does cause harmful interference to radio or television reception, which can be determined by turning the equipment off and on, the user is encouraged to try to correct the interference by one or more of the following measures:

- Reorient or relocate the receiving antenna.
- Increase the separation between the equipment and receiver.
- Connect the equipment into an outlet on a circuit different from that to which the receiver is connected.
- Consult the dealer or an experienced radio/TV technician for help.

Warning: Any changes or modifications to this unit not expressly approved by the party responsible for compliance could void the user's authority to operate the equipment.

This equipment complies with Part 68 of the FCC rules and the requirements adopted by the ACTA. On the bottom of this equipment is a label that contains, among other information, a product identifier in the format US: 311PNANH1. If requested, this number must be provided to the telephone company.



Fanvil Technology Co., Ltd

Website: www.fanvil.com

E-Mail: sales@fanvil.com support@fanvil.com

Tel: +86-755-2640-2199 Fax: +86-755-2640-2618

Add: 10/F Block A, Dualshine Global Science Innovation Center, Honglang North 2nd Road, Bao'an District, Shenzhen, China